

Bid Date -

** ESTIMATING BAR LIST **

LINE	LA	EP	A/D	STRUCTURE	MULT	REQ	CODE	+	X	QTY	SZ/GR	LENGTH	B	COMMENT	LINE LB
32				4.PODIUM SLAB BOTTOM MAT. (NO REINF.DETAILS)											
33				5.SITEWORK (EXCEPT BOLLARD AT SLAB,TRASH COMPACTOR											
34				& AIR ENTRAINED)											
35															
36				INCLUSIONS:											
37				1.SPREAD FOOTING											
38				2.MAT FOOTING											
39				3.CONCRETE COLUMN											
40				4.CONTINUES FOOTING											
41				5.CONCRETE WALL											
42				6.SLAB ON GRADE											
43				7.CONCRETE SHEARWALL											
44				8.CMU WALL											
45				9.UPPER LEVEL											
46				10.SITEWORK											
47															
48				ASSUMPTIONS:											
49				1.WE ASSUMED 15% MORE AREA FOR MESH LAPPING.											
50															
51				NOTES:											
52				1.REBAR ACCESSORIES: AS PER STANDARD PRACTICE											
53															
54				SPREAD FTG										SPREAD FOOTING	
55				MARK = F2.0 (2 -LOC)(REF.-S1.01)											
56						2			2	3	#4	3-04	L	3-#4 EW BOT	27
57				MARK = F4.5 (4 -LOC)											
58						4			2	4	#4	6-00	L	4-#4 EW BOT	128
59				MARK = F5.0 (3 -LOC)											
60						3			2	4	#5	5-00		4-#5 EW BOT	125
61				MARK = F5.5 (3 -LOC)											
62						3			2	5	#5	5-06		5-#5 EW BOT	172

Bid Date -

** ESTIMATING BAR LIST **

LINE	LA	EP	A/D	STRUCTURE	MULT	REQ	CODE	+	X	QTY	SZ/GR	LENGTH	B	COMMENT	LINE LB
63 MARK = F7.0 (4 -LOC)															
64						4			2	7	#6	7-00		7-#6 EW BOT	589
65 MARK = F8.0 (2 -LOC)															
66						2			2	7	#7	8-00		7-#7 EW BOT	458
67 MARK = F8.5 (2 -LOC)															
68						2			2	8	#7	8-06		8-#7 EW BOT	556
69 MARK = F9.0 (5 -LOC)															
70						5			2	9	#7	9-00		9-#7 EW BOT	1656
71 MARK = F9.5 (2 -LOC)															
72						2			2	9	#8	9-06		9-#8 EW BOT	913
73 MARK = F10.0 (1 -LOC)															
74									2	9	#8	10-00		9-#8 EW BOT	481
75 MARK = F10.5 (3 -LOC)															
76						3			2	10	#8	10-06		10-#8 EW BOT	1682
77 MARK = F11.0 (1 -LOC)															
78									2	10	#8	11-00		10-#8 EW BOT	587
79 MARK = F11.5 (1 -LOC)															
80									2	11	#8	11-06		11-#8 EW BOT	676
81 MARK = F12.0 (3 -LOC)															
82						3			2	12	#8	12-00		12-#8 EW BOT	2307
83 MARK = F12.5 (1 -LOC)															
84									2	11	#8	12-06		12-#8 EW BOT	734
85															
86 MAT FOOTING MAT FOOTING															
87 REF.-(S1.01)(300 SQ.FT)															
88										22	#7	40-00		#7 @10" EW BOT	1799
89										23	#8	40-00		#8 @10" EW TOP	2456
90										21	#5	8-04	H	#5 @48" STANDEE	183
91 REF.-(S1.01)(603 SQ.FT)															
92										36	#8	40-00		#8 @12" EW BOT	3845
93										43	#8	40-00		#8 @10" EW TOP	4592

Bid Date -

** ESTIMATING BAR LIST **

LINE	LA	EP	A/D	STRUCTURE	MULT	REQ	CODE	+	X	QTY	SZ/GR	LENGTH	B	COMMENT	LINE LB
94										44	#5	8-08	H	#5 @48" STANDEE	398
95 REF.-(S1.01)(213 SQ.FT)															
96										14	#8	40-00		#8 @12" EW TOP	1495
97										16	#8	40-00		#8 @10" EW BOT	1709
98										18	#5	8-08	H	#5 @48" STANDEE	163
99 STAIR 1															
100 REF.-(1/S1.10)(685 SQ.FT)															
101										22	#8	40-00		#8 @12" LW BOT	2350
102										12	#8	22-00		#8 @12" SW BOT	705
103										48	#8	22-00		#8 @6" SW BOT	2820
104										50	#7	40-00	H	#7 @10" EW TOP	4088
105										48	#5	8-08	H	#5 @48" STANDEE	434
106 STAIR 2															
107 REF.-(3/S1.10)(655 SQ.FT)															
108										40	#8	40-00		#8 @12" EW BOT	4272
109										50	#7	40-00	H	#7 @10" EW TOP	4088
110										20	#8	13-00		#8 @12" ADDL BOT	694
111										44	#5	8-00	H	#5 @48" STANDEE	367
112 ELEVATOR															
113 REF.-(2/S1.10)(735 SQ.FT)															
114										62	#7	40-00	H	#7 @10" EW TOP	5069
115										21	#8	39-00		#8 @12" LW BOT	2187
116										50	#8	20-00		#8 @6" SW BOT	2670
117										16	#8	20-00		#8 @12" SW BOT	854
118										105	#5	8-08	H	#5 @48" STANDEE	949
119															
				CONC. COLUMN		CONCRETE COLUMN									
121 REFER = S1.01 & S5.40															
122 LEVEL = 1 TO LEVEL = 9 LOW ROOF TOP															
123 MARK = A-1,A-2,A-3,A-4,A-5 (5 LOC)															
124					5					4	#8	8-03	H	4-#8 DWL	441

Bid Date -

** ESTIMATING BAR LIST **

LINE	LA	EP	A/D	STRUCTURE	MULT	REQ	CODE	+	X	QTY	SZ/GR	LENGTH	B	COMMENT	LINE LB
125					5					10	#7	125-00		10-#7 VERT	12775
126					5					85	#3	7-08	L	#3 @14" TIES	1225
127					5					85	#3	5-00	L	#3 @14" TIES	799
128					5					85	#3	3-04	L	#3 @14" LINKS	533
129					5				15	7	#3	7-08	L	7-#3 ADDL TIES	1513
130					5				15	7	#3	5-00	L	7-#3 ADDL TIES	987
131					5				15	7	#3	3-04	L	7-#3 ADDL LINKS	658
132															
133														LEVEL = 1 TO LEVEL = 2	
134														MARK = A.5-6 (1 LOC)	
135										4	#8	8-03	H	4-#8 DWL	88
136										8	#7	23-04		8-#7 VERT	382
137										15	#3	6-04	L	#3 @14" TIES	36
138										7	#3	6-04	L	7-#3 ADDL TIES	17
139														LEVEL = 2 TO LEVEL = 10 HIGH ROOF	
140														MARK = A.5-6 (1 LOC)	
141										10	#7	122-04		10-#7 VERT	2500
142										85	#3	7-08	L	#3 @14" TIES	245
143										85	#3	5-00	L	#3 @14" TIES	160
144										85	#3	3-04	L	#3 @14" LINKS	107
145									15	7	#3	7-08	L	7-#3 ADDL TIES	303
146									15	7	#3	5-00	L	7-#3 ADDL TIES	197
147									15	7	#3	3-04	L	7-#3 ADDL LINKS	132
148															
149														LEVEL = 1 TO LEVEL = 2	
150														MARK = A.5-7 (1 LOC)	
151										4	#8	8-03	H	4-#8 DWL	88
152										8	#7	23-04		8-#7 VERT	382
153										15	#3	6-04	L	#3 @14" TIES	36
154										7	#3	6-04	L	7-#3 ADDL TIES	17
155														LEVEL = 2 TO LEVEL = 10 HIGH ROOF	

Bid Date -

** ESTIMATING BAR LIST **

LINE	LA	EP	A/D	STRUCTURE	MULT	REQ	CODE	+	X	QTY	SZ/GR	LENGTH	B	COMMENT	LINE LB
156 MARK = A.5-7 (1 LOC)															
157										10	#7	123-08		10-#7 VERT	2528
158										85	#3	7-08	L	#3 @14" TIES	245
159										85	#3	5-00	L	#3 @14" TIES	160
160										85	#3	3-04	L	#3 @14" LINKS	107
161									15	7	#3	7-08	L	7-#3 ADDL TIES	303
162									15	7	#3	5-00	L	7-#3 ADDL TIES	197
163									15	7	#3	3-04	L	7-#3 ADDL LINKS	132
164															
165 LEVEL = 1 TO LEVEL = 10 HIGH ROOF															
166 MARK = B-1,B-2 (2 LOC)															
167					2					4	#8	8-03	H	4-#8 DWL	176
168					2					10	#7	145-06		10-#7 VERT	5948
169					2					95	#3	7-08	L	#3 @14" TIES	548
170					2					95	#3	5-00	L	#3 @14" TIES	357
171					2					95	#3	3-04	L	#3 @14" LINKS	238
172					2				17	7	#3	7-08	L	7-#3 ADDL TIES	686
173					2				17	7	#3	5-00	L	7-#3 ADDL TIES	447
174					2				17	7	#3	3-04	L	7-#3 ADDL LINKS	298
175															
176 LEVEL = 1 TO LEVEL = 2															
177 MARK = B-3 (1 LOC)															
178										4	#8	8-03	H	4-#8 DWL	88
179										8	#7	23-04		8-#7 VERT	382
180										15	#3	6-04	L	#3 @14" TIES	36
181										7	#3	6-04	L	7-#3 ADDL TIES	17
182 LEVEL = 2 TO LEVEL = 10 HIGH ROOF															
183 MARK = B-3 (1 LOC)															
184										10	#7	122-04		10-#7 VERT	2500
185										85	#3	7-08	L	#3 @14" TIES	245
186										85	#3	5-00	L	#3 @14" TIES	160

Bid Date -

** ESTIMATING BAR LIST **

LINE	LA	EP	A/D	STRUCTURE	MULT	REQ	CODE	+	X	QTY	SZ/GR	LENGTH	B	COMMENT	LINE LB
187										85	#3	3-04	L	#3 @14" LINKS	107
188									15	7	#3	7-08	L	7-#3 ADDL TIES	303
189									15	7	#3	5-00	L	7-#3 ADDL TIES	197
190									15	7	#3	3-04	L	7-#3 ADDL LINKS	132
191															
192 LEVEL = 1 TO LEVEL = 10 HIGH ROOF															
193 MARK = B-4 (1 LOC)															
194										4	#8	8-03	H	4-#8 DWL	88
195										10	#7	145-06		10-#7 VERT	2974
196										95	#3	7-08	L	#3 @14" TIES	274
197										95	#3	5-00	L	#3 @14" TIES	179
198										95	#3	3-04	L	#3 @14" LINKS	119
199										17	7	7-08	L	7-#3 ADDL TIES	343
200										17	7	5-00	L	7-#3 ADDL TIES	224
201										17	7	3-04	L	7-#3 ADDL LINKS	149
202															
203 LEVEL = 1 TO LEVEL = 2															
204 MARK = B-6.1 (1 LOC)															
205										4	#8	8-03	H	4-#8 DWL	88
206										8	#7	26-09		8-#7 VERT	437
207										20	#3	6-04	L	#3 @14" TIES	48
208										7	#3	6-04	L	7-#3 ADDL TIES	17
209 LEVEL = 2 TO LEVEL = 10 HIGH ROOF															
210 MARK = B-6.1 (1 LOC)															
211										10	#7	122-04		10-#7 VERT	2500
212										85	#3	7-08	L	#3 @14" TIES	245
213										85	#3	5-00	L	#3 @14" TIES	160
214										85	#3	3-04	L	#3 @14" LINKS	107
215									15	7	#3	7-08	L	7-#3 ADDL TIES	303
216									15	7	#3	5-00	L	7-#3 ADDL TIES	197
217									15	7	#3	3-04	L	7-#3 ADDL LINKS	132

Bid Date -

** ESTIMATING BAR LIST **

LINE	LA	EP	A/D	STRUCTURE	MULT	REQ	CODE	+	X	QTY	SZ/GR	LENGTH	B	COMMENT	LINE LB
218															
219 LEVEL = 9 LOW ROOF TOP TO LEVEL = 10 HIGH ROOF															
220 MARK = B(-2'-5")-7 (1 LOC)															
221										10	#7	8-03	H	10-#7 DWL	169
222										10	#7	21-04		10-#7 VERT	436
223										25	#3	7-08	L	#3 @14" TIES	72
224										25	#3	5-00	L	#3 @14" TIES	47
225										25	#3	3-04	L	#3 @14" LINKS	31
226									2	7	#3	7-08	L	7-#3 ADDL TIES	40
227									2	7	#3	5-00	L	7-#3 ADDL TIES	26
228									2	7	#3	3-04	L	7-#3 ADDL LINKS	18
229															
230 LEVEL = 1 TO LEVEL = 2															
231 MARK = C-2 (1 LOC)															
232										4	#8	8-03	H	4-#8 DWL	88
233										8	#7	23-04		8-#7 VERT	382
234										15	#3	6-04	L	#3 @14" TIES	36
235										7	#3	6-04	L	7-#3 ADDL TIES	17
236 LEVEL = 2 TO LEVEL = 10 HIGH ROOF															
237 MARK = C-2 (1 LOC)															
238										10	#7	122-04		10-#7 VERT	2500
239										85	#3	7-08	L	#3 @14" TIES	245
240										85	#3	5-00	L	#3 @14" TIES	160
241										85	#3	3-04	L	#3 @14" LINKS	107
242									15	7	#3	7-08	L	7-#3 ADDL TIES	303
243									15	7	#3	5-00	L	7-#3 ADDL TIES	197
244									15	7	#3	3-04	L	7-#3 ADDL LINKS	132
245															
246 LEVEL = 1 TO LEVEL = 2															
247 MARK = C-3 (1 LOC)															
248										4	#8	8-03	H	4-#8 DWL	88

Bid Date -

**** ESTIMATING BAR LIST ****

LINE	LA	EP	A/D	STRUCTURE	MULT	REQ	CODE	+	X	QTY	SZ/GR	LENGTH	B	COMMENT	LINE LB
249										8	#7	23-04		8-#7 VERT	382
250										15	#3	6-04	L	#3 @14" TIES	36
251										7	#3	6-04	L	7-#3 ADDL TIES	17
252 LEVEL = 2 TO LEVEL = 3															
253 MARK = C-3 (1 LOC)															
254										10	#7	10-08		10-#7 VERT	218
255										10	#3	7-08	L	#3 @14" TIES	29
256										10	#3	5-00	L	#3 @14" TIES	19
257										10	#3	3-04	L	#3 @14" LINKS	13
258									3	7	#3	7-08	L	7-#3 ADDL TIES	61
259									3	7	#3	5-00	L	7-#3 ADDL TIES	39
260									3	7	#3	3-04	L	7-#3 ADDL LINKS	26
261															
262 LEVEL = 1 TO LEVEL = 3															
263 MARK = C-4 (1 LOC)															
264										4	#8	8-03	H	4-#8 DWL	88
265										10	#7	34-00		10-#7 VERT	695
266										10	#3	7-08	L	#3 @14" TIES	29
267										10	#3	5-00	L	#3 @14" TIES	19
268										10	#3	3-04	L	#3 @14" LINKS	13
269									3	7	#3	7-08	L	7-#3 ADDL TIES	61
270									3	7	#3	5-00	L	7-#3 ADDL TIES	39
271									3	7	#3	3-04	L	7-#3 ADDL LINKS	26
272															
273 LEVEL = 1 TO LEVEL = 10 HIGH ROOF															
274 MARK = D-2 (1 LOC)															
275										4	#8	8-03	H	4-#8 DWL	88
276										10	#7	145-06		10-#7 VERT	2974
277										95	#3	7-08	L	#3 @14" TIES	274
278										95	#3	5-00	L	#3 @14" TIES	179
279										95	#3	3-04	L	#3 @14" LINKS	119

Bid Date -

** ESTIMATING BAR LIST **

LINE	LA	EP	A/D	STRUCTURE	MULT	REQ	CODE	+	X	QTY	SZ/GR	LENGTH	B	COMMENT	LINE LB
280										17	7 #3	7-08	L	7-#3 ADDL TIES	343
281										17	7 #3	5-00	L	7-#3 ADDL TIES	224
282										17	7 #3	3-04	L	7-#3 ADDL LINKS	149
283															
284 LEVEL = 1 TO LEVEL = 3															
285 MARK = D-3,D-4 (1 LOC)															
286										4	#8	8-03	H	4-#8 DWL	88
287										10	#7	34-04		10-#7 VERT	702
288										10	#3	7-08	L	#3 @14" TIES	29
289										10	#3	5-00	L	#3 @14" TIES	19
290										10	#3	3-04	L	#3 @14" LINKS	13
291										3	7 #3	7-08	L	7-#3 ADDL TIES	61
292										3	7 #3	5-00	L	7-#3 ADDL TIES	39
293										3	7 #3	3-04	L	7-#3 ADDL LINKS	26
294															
295 LEVEL = 1 TO LEVEL = 10 HIGH ROOF															
296 MARK = D-2 (1 LOC)															
297										4	#8	8-03	H	4-#8 DWL	88
298										10	#7	149-00		10-#7 VERT	3046
299										100	#3	7-08	L	#3 @14" TIES	288
300										100	#3	5-00	L	#3 @14" TIES	188
301										100	#3	3-04	L	#3 @14" LINKS	125
302										17	7 #3	7-08	L	7-#3 ADDL TIES	343
303										17	7 #3	5-00	L	7-#3 ADDL TIES	224
304										17	7 #3	3-04	L	7-#3 ADDL LINKS	149
305															
306 LEVEL = 1 TO LEVEL = 9 LOW ROOF TOP															
307 MARK = AA-5 (1 LOC)															
308										4	#8	8-03	H	4-#8 DWL	88
309										10	#7	125-00		10-#7 VERT	2555
310										85	#3	7-08	L	#3 @14" TIES	245

Bid Date -

**** ESTIMATING BAR LIST ****

LINE	LA	EP	A/D	STRUCTURE	MULT	REQ	CODE	+	X	QTY	SZ/GR	LENGTH	B	COMMENT	LINE LB
311										85	#3	5-00	L	#3 @14" TIES	160
312										85	#3	3-04	L	#3 @14" LINKS	107
313									15	7	#3	7-08	L	7-#3 ADDL TIES	303
314									15	7	#3	5-00	L	7-#3 ADDL TIES	197
315									15	7	#3	3-04	L	7-#3 ADDL LINKS	132
316															
317 LEVEL = 1 TO LEVEL = 10 HIGH ROOF															
318 MARK = AA-6 (1 LOC)															
319										4	#8	8-03	H	4-#8 DWL	88
320										10	#7	145-06		10-#7 VERT	2974
321										95	#3	7-08	L	#3 @14" TIES	274
322										95	#3	5-00	L	#3 @14" TIES	179
323										95	#3	3-04	L	#3 @14" LINKS	119
324									17	7	#3	7-08	L	7-#3 ADDL TIES	343
325									17	7	#3	5-00	L	7-#3 ADDL TIES	224
326									17	7	#3	3-04	L	7-#3 ADDL LINKS	149
327															
328 LEVEL = 1 TO LEVEL = 10 HIGH ROOF															
329 MARK = AA-7 (1 LOC)															
330										4	#8	8-03	H	4-#8 DWL	88
331										10	#7	147-00		10-#7 VERT	3005
332										100	#3	7-08	L	#3 @14" TIES	288
333										100	#3	5-00	L	#3 @14" TIES	188
334										100	#3	3-04	L	#3 @14" LINKS	125
335									17	7	#3	7-08	L	7-#3 ADDL TIES	343
336									17	7	#3	5-00	L	7-#3 ADDL TIES	224
337									17	7	#3	3-04	L	7-#3 ADDL LINKS	149
338															
339 LEVEL = 1 TO LEVEL = 2															
340 MARK = X1-X7,X1-XD (2 LOC)															
341					2					4	#8	8-03	H	4-#8 DWL	176

Bid Date -

** ESTIMATING BAR LIST **

LINE	LA	EP	A/D	STRUCTURE	MULT	REQ	CODE	+	X	QTY	SZ/GR	LENGTH	B	COMMENT	LINE LB
342					2					10	#7	20-04		10-#7 VERT	831
343					2					10	#3	7-08	L	#3 @14" TIES	58
344					2					10	#3	5-00	L	#3 @14" TIES	38
345					2					10	#3	3-04	L	#3 @14" LINKS	25
346					2					7	#3	7-08	L	7-#3 ADDL TIES	40
347					2					7	#3	5-00	L	7-#3 ADDL TIES	26
348					2					7	#3	3-04	L	7-#3 ADDL LINKS	18
349															
350 LEVEL = 1 TO LEVEL = 2															
351 MARK = X1.5-XE,X1.5-XF (2 LOC)															
352					2					4	#8	8-03	H	4-#8 DWL	176
353					2					10	#7	21-04		10-#7 VERT	872
354					2					10	#3	7-08	L	#3 @14" TIES	58
355					2					10	#3	5-00	L	#3 @14" TIES	38
356					2					10	#3	3-04	L	#3 @14" LINKS	25
357					2					7	#3	7-08	L	7-#3 ADDL TIES	40
358					2					7	#3	5-00	L	7-#3 ADDL TIES	26
359					2					7	#3	3-04	L	7-#3 ADDL LINKS	18
360															
361 LEVEL = 1 TO LEVEL = 10 HIGH ROOF															
362 MARK = X2-XD,X2-XE (2 LOC)															
363					2					4	#8	8-03	H	4-#8 DWL	176
364					2					10	#7	145-06		10-#7 VERT	5948
365					2					95	#3	7-08	L	#3 @14" TIES	548
366					2					95	#3	5-00	L	#3 @14" TIES	357
367					2					95	#3	3-04	L	#3 @14" LINKS	238
368					2				17	7	#3	7-08	L	7-#3 ADDL TIES	686
369					2				17	7	#3	5-00	L	7-#3 ADDL TIES	447
370					2				17	7	#3	3-04	L	7-#3 ADDL LINKS	298
371															
372 LEVEL = 1 TO LEVEL = 10 HIGH ROOF															

Bid Date -

** ESTIMATING BAR LIST **

LINE	LA	EP	A/D	STRUCTURE	MULT	REQ	CODE	+	X	QTY	SZ/GR	LENGTH	B	COMMENT	LINE LB
373 MARK = X2-XF (1 LOC)															
374										4	#8	8-03	H	4-#8 DWL	88
375										10	#7	148-04		10-#7 VERT	3032
376										100	#3	7-08	L	#3 @14" TIES	288
377										100	#3	5-00	L	#3 @14" TIES	188
378										100	#3	3-04	L	#3 @14" LINKS	125
379									17	7	#3	7-08	L	7-#3 ADDL TIES	343
380									17	7	#3	5-00	L	7-#3 ADDL TIES	224
381									17	7	#3	3-04	L	7-#3 ADDL LINKS	149
382															
383 LEVEL = 1 TO LEVEL = 10 HIGH ROOF															
384 MARK = X3-XD,X3-XE (2 LOC)															
385					2					4	#8	8-03	H	4-#8 DWL	176
386					2					10	#7	147-06		10-#7 VERT	6030
387					2					85	#3	7-08	L	#3 @14" TIES	490
388					2					85	#3	5-00	L	#3 @14" TIES	320
389					2					85	#3	3-04	L	#3 @14" LINKS	213
390					2				17	7	#3	7-08	L	7-#3 ADDL TIES	686
391					2				17	7	#3	5-00	L	7-#3 ADDL TIES	447
392					2				17	7	#3	3-04	L	7-#3 ADDL LINKS	298
393															
394 LEVEL = 1 TO LEVEL = 10 HIGH ROOF															
395 MARK = X3-XD,X3-XE (2 LOC)															
396					2					4	#8	8-03	H	4-#8 DWL	176
397					2					10	#7	147-06		10-#7 VERT	6030
398					2					85	#3	7-08	L	#3 @14" TIES	490
399					2					85	#3	5-00	L	#3 @14" TIES	320
400					2					85	#3	3-04	L	#3 @14" LINKS	213
401					2				17	7	#3	7-08	L	7-#3 ADDL TIES	686
402					2				17	7	#3	5-00	L	7-#3 ADDL TIES	447
403					2				17	7	#3	3-04	L	7-#3 ADDL LINKS	298

Bid Date -

**** ESTIMATING BAR LIST ****

LINE	LA	EP	A/D	STRUCTURE	MULT	REQ	CODE	+	X	QTY	SZ/GR	LENGTH	B	COMMENT	LINE LB
404															
405 LEVEL = 1 TO LEVEL = 10 HIGH ROOF															
406 MARK = X3-XD,X3-XE (2 LOC)															
407					2					4	#8	8-03	H	4-#8 DWL	176
408					2					10	#7	151-00		10-#7 VERT	6173
409					2					110	#3	7-08	L	#3 @14" TIES	634
410					2					110	#3	5-00	L	#3 @14" TIES	414
411					2					110	#3	3-04	L	#3 @14" LINKS	276
412					2					17	7 #3	7-08	L	7-#3 ADDL TIES	686
413					2					17	7 #3	5-00	L	7-#3 ADDL TIES	447
414					2					17	7 #3	3-04	L	7-#3 ADDL LINKS	298
415															
416 LEVEL = 9 LOW ROOF TOP TO LEVEL = 10 HIGH ROOF															
417 MARK = X3(9'-1")XF(1 LOC)															
418										10	#6	8-03	H	10-#6 DWL	124
419										10	#6	20-05		10-#6 VERT	307
420										25	#3	7-08	L	#3 @14" TIES	72
421										25	#3	5-00	L	#3 @14" TIES	47
422										25	#3	3-04	L	#3 @14" LINKS	31
423									2	7	#3	7-08	L	7-#3 ADDL TIES	40
424									2	7	#3	5-00	L	7-#3 ADDL TIES	26
425									2	7	#3	3-04	L	7-#3 ADDL LINKS	18
426															
427 LEVEL = 1 TO LEVEL = 9 LOW ROOF TOP															
428 MARK = X4-XA (1 LOC)															
429										4	#8	8-03	H	4-#8 DWL	88
430										10	#7	127-09		10-#7 VERT	2611
431										90	#3	7-08	L	#3 @14" TIES	259
432										90	#3	5-00	L	#3 @14" TIES	169
433										90	#3	3-04	L	#3 @14" LINKS	113
434									15	7	#3	7-08	L	7-#3 ADDL TIES	303

Bid Date -

**** ESTIMATING BAR LIST ****

LINE	LA	EP	A/D	STRUCTURE	MULT	REQ	CODE	+	X	QTY	SZ/GR	LENGTH	B	COMMENT	LINE LB
435										15	7 #3	5-00	L	7-#3 ADDL TIES	197
436										15	7 #3	3-04	L	7-#3 ADDL LINKS	132
437															
438 LEVEL = 1 TO LEVEL = 2															
439 MARK = X4-XB,X4-XC (2 LOC)															
440					2					4	#8	8-03	H	4-#8 DWL	176
441					2					8	#7	23-04		8-#7 VERT	763
442					2					15	#3	6-04	L	#3 @14" TIES	71
443					2					7	#3	6-04	L	7-#3 ADDL TIES	33
444 LEVEL = 2 TO LEVEL = 9 LOW ROOF TOP															
445 MARK = X4-XB,X4-XC (2 LOC)															
446					2					10	#7	103-04		10-#7 VERT	4224
447					2					70	#3	7-08	L	#3 @14" TIES	404
448					2					70	#3	5-00	L	#3 @14" TIES	263
449					2					70	#3	3-04	L	#3 @14" LINKS	175
450					2				15	7	#3	7-08	L	7-#3 ADDL TIES	605
451					2				15	7	#3	5-00	L	7-#3 ADDL TIES	395
452					2				15	7	#3	3-04	L	7-#3 ADDL LINKS	263
453															
454 LEVEL = 1 TO LEVEL = 9 LOW ROOF TOP															
455 MARK = X4-XD (1 LOC)															
456										4	#8	8-03	H	4-#8 DWL	88
457										10	#7	126-05		10-#7 VERT	2584
458										85	#3	7-08	L	#3 @14" TIES	245
459										85	#3	5-00	L	#3 @14" TIES	160
460										85	#3	3-04	L	#3 @14" LINKS	107
461									15	7	#3	7-08	L	7-#3 ADDL TIES	303
462									15	7	#3	5-00	L	7-#3 ADDL TIES	197
463									15	7	#3	3-04	L	7-#3 ADDL LINKS	132
464															
465 LEVEL = 1 TO LEVEL = 9 LOW ROOF TOP															

Bid Date -

** ESTIMATING BAR LIST **

LINE	LA	EP	A/D	STRUCTURE	MULT	REQ	CODE	+	X	QTY	SZ/GR	LENGTH	B	COMMENT	LINE LB
466 MARK = X4-XE (1 LOC)															
467										4	#8	8-03	H	4-#8 DWL	88
468										10	#7	129-04		10-#7 VERT	2644
469										85	#3	7-08	L	#3 @14" TIES	245
470										85	#3	5-00	L	#3 @14" TIES	160
471										85	#3	3-04	L	#3 @14" LINKS	107
472									15	7	#3	7-08	L	7-#3 ADDL TIES	303
473									15	7	#3	5-00	L	7-#3 ADDL TIES	197
474									15	7	#3	3-04	L	7-#3 ADDL LINKS	132
475															
476 LEVEL = 9 LOW ROOF TOP TO LEVEL = 10 HIGH ROOF															
477 MARK = X4.3-XB,X4.3-XC,X4.3-XD,X4.3-XE(4 LOC)															
478					4					10	#7	8-03	H	10-#7 DWL	675
479					4					10	#7	21-04		10-#7 VERT	1744
480					4					25	#3	7-08	L	#3 @14" TIES	288
481					4					25	#3	5-00	L	#3 @14" TIES	188
482					4					25	#3	3-04	L	#3 @14" LINKS	125
483					4				2	7	#3	7-08	L	7-#3 ADDL TIES	161
484					4				2	7	#3	5-00	L	7-#3 ADDL TIES	105
485					4				2	7	#3	3-04	L	7-#3 ADDL LINKS	70
486															
487 LEVEL = 1 TO LEVEL = 9 LOW ROOF TOP															
488 MARK = X5-XA (1 LOC)															
489										4	#8	8-03	H	4-#8 DWL	88
490										10	#7	128-00		10-#7 VERT	2616
491										85	#3	7-08	L	#3 @14" TIES	245
492										85	#3	5-00	L	#3 @14" TIES	160
493										85	#3	3-04	L	#3 @14" LINKS	107
494									15	7	#3	7-08	L	7-#3 ADDL TIES	303
495									15	7	#3	5-00	L	7-#3 ADDL TIES	197
496									15	7	#3	3-04	L	7-#3 ADDL LINKS	132

Bid Date -

** ESTIMATING BAR LIST **

LINE	LA	EP	A/D	STRUCTURE	MULT	REQ	CODE	+	X	QTY	SZ/GR	LENGTH	B	COMMENT	LINE LB
497															
498 LEVEL = 1 TO LEVEL = 10 HIGH ROOF															
499 MARK = X5-XB,X5-XC,X5-XD (3 LOC)															
500					3					4	#8	8-03	H	4-#8 DWL	264
501					3					10	#7	152-04		10-#7 VERT	9341
502					3					100	#3	7-08	L	#3 @14" TIES	865
503					3					100	#3	5-00	L	#3 @14" TIES	564
504					3					100	#3	3-04	L	#3 @14" LINKS	376
505					3					19	7 #3	7-08	L	7-#3 ADDL TIES	1150
506					3					19	7 #3	5-00	L	7-#3 ADDL TIES	750
507					3					19	7 #3	3-04	L	7-#3 ADDL LINKS	500
508															
509 LEVEL = 1 TO LEVEL = 10 HIGH ROOF															
510 MARK = X5-XB,X5-XC,X5-XD (3 LOC)															
511					3					4	#8	8-03	H	4-#8 DWL	264
512					3					10	#7	152-04		10-#7 VERT	9341
513					3					100	#3	7-08	L	#3 @14" TIES	865
514					3					100	#3	5-00	L	#3 @14" TIES	564
515					3					100	#3	3-04	L	#3 @14" LINKS	376
516					3					19	7 #3	7-08	L	7-#3 ADDL TIES	1150
517					3					19	7 #3	5-00	L	7-#3 ADDL TIES	750
518					3					19	7 #3	3-04	L	7-#3 ADDL LINKS	500
519															
520 LEVEL = 9 LOW ROOF TOP TO LEVEL = 10 HIGH ROOF															
521 MARK = X5(-1'-4 1/4")-XF(8-3/8") (1 LOC)															
522										10	#6	8-03	H	10-#6 DWL	124
523										10	#6	21-04		10-#6 VERT	320
524										25	#3	7-08	L	#3 @14" TIES	72
525										25	#3	5-00	L	#3 @14" TIES	47
526										25	#3	3-04	L	#3 @14" LINKS	31
527									2	7	#3	7-08	L	7-#3 ADDL TIES	40

Bid Date -

**** ESTIMATING BAR LIST ****

LINE	LA	EP	A/D	STRUCTURE	MULT	REQ	CODE	+	X	QTY	SZ/GR	LENGTH	B	COMMENT	LINE LB
528									2	7	#3	5-00	L	7-#3 ADDL TIES	26
529									2	7	#3	3-04	L	7-#3 ADDL LINKS	18
530															
531 COLUMN TOP DWL															
532									47	10	#7	8-03	H	10-#7 DWL	7926
533									2	10	#6	8-03	H	10-#6 DWL	248
534															
535 CONTINUES FTG CONTINUES FOOTING															
536 REF.-(10/S3.03)(100 -LFT)															
537						3			2	6	#4	40-00		6-#4 CONT T&B	962
538										68	#4	3-00		#4 @18" TRANS BOT	136
539										88	#4	3-00		#4 @14" TRANS TOP	176
540										52	#4	5-08	L	#4 @48" STANDEE	197
541									2	105	#4	4-10	L	#4 @12" DWL EF	678
542						3			2	6	#4	5-00	L	6-#4 COR T&B	120
543 REF.-(14/S3.03)(65 -LFT)															
544						2			2	3	#4	40-00		3-#4 CONT T&B	321
545									2	58	#4	3-00		#4 @14" TRANS TOP	232
546										50	#4	5-08	L	#4 @48" STANDEE	189
547										68	#4	4-06	L	#4 @12" DWL	204
548															
549 CONC.WALL CONCRETE WALL															
550 REF.-(10/S3.03)(100 -LFT)															
551									2	102	#4	5-00		#4 @12" VERT EF	681
552						3			2	4	#4	40-00		#4 @18" HOR EF	641
553						3			2	4	#4	4-10	L	#4 @18" COR EF	77
554										70	#4	5-06	L	#4 @18" DWL	257
555 REF.-(14/S3.03)(65 -LFT)															
556										68	#4	5-00		#4 @12" VERT	227
557									2	4	#4	40-00		#4 @12" HOR	214
558									2	4	#4	4-10	L	#4 @12" COR	26

Bid Date -

** ESTIMATING BAR LIST **

LINE	LA	EP	A/D	STRUCTURE	MULT	REQ	CODE	+	X	QTY	SZ/GR	LENGTH	B	COMMENT	LINE LB
590										4	#4	40-00		#4 @16" EW	107
591									11	1	#3	5-00		1-#3 NOSING	21
592 REF.-(8/S3.01)(30 -LFT)															
593										3	#5	30-00		3-#5 CONT	94
594										32	#4	2-00		#4 @12" TRANS	43
595										2	#5	30-00		2-#5 CONT	63
596										21	#4	5-00	L	#4 @18" DWL	70
597 REF.-(1/S1.01)(11 -LOC)															
598									11	2	#4	4-00		2-#4 RE-ENT	59
599															
600 5" THICK SLAB ON GRADE															
601 MESH TYPE = 6x6-W2.9xW2.9 WWR															
602 SHEET SIZE = 12'-6" x 8'-0"															
603 AREA = 11175 SQ.FT															
604 NO.OF SHEETS = 129 NOS															
605															
606 TRASH AND RECYCLING ROOM															
607 REF.-(S1.01)(1415 SQ.FT)															
608										80	#4	40-00		#4 @12" EW	2138
609 CMU WALL DWL															
610 REF.-(10/S3.03)															
611										40	#5	5-06	H	#5 @48" CMU DWL	229
612															
613 SHEARWALL CONCRETE SHEARWALL															
614 STAIR = 1															
615 REFER = S6.31															
616 MARK = SW1-1															
617									2	15	#4	8-00	L	#4 @12" DWL EF	160
618									2	15	#4	137-00		#4 @12" VERT EF	2745
619									2	115	#4	15-00		#4 @12" HOR EF	2305
620									2	115	#4	5-06	L	#4 @12" U-BAR ES	845

Bid Date -

** ESTIMATING BAR LIST **

LINE	LA	EP	A/D	STRUCTURE	MULT	REQ	CODE	+	X	QTY	SZ/GR	LENGTH	B	COMMENT	LINE LB
621									32	2	#5	4-00		2-#5 DIG	267
622										87	#3	2-00	L	#3 @48" LINKS	65
623															
624 MARK = SW1-2															
625									2	23	#4	8-00	L	#4 @12" DWL EF	246
626									2	23	#4	137-00		#4 @12" VERT EF	4210
627									2	115	#4	22-00		#4 @12" HOR EF	3380
628									2	115	#4	5-06	L	#4 @12" U-BAR ES	845
629									18	2	#5	4-00		2-#5 DIG	150
630										203	#3	2-00	L	#3 @48" LINKS	153
631															
632 MARK = SW1-3															
633									2	15	#4	8-00	L	#4 @12" DWL EF	160
634									2	15	#4	137-00		#4 @12" VERT EF	2745
635									2	115	#4	15-00		#4 @12" HOR EF	2305
636									2	115	#4	5-06	L	#4 @12" U-BAR ES	845
637										87	#3	2-00	L	#3 @48" LINKS	65
638															
639 STAIR = 2															
640 MARK = SW2-1															
641									2	15	#5	8-00	H	#5 @12" DWL EF	250
642									2	15	#5	25-00		#5 @12" VERT EF	782
643									2	15	#4	96-08		#4 @12" VERT EF	1937
644									2	103	#4	15-00		#4 @12" HOR EF	2064
645									2	103	#4	5-06	L	#4 @12" U-BAR ES	757
646									36	2	#5	4-00		2-#5 DIG	300
647										87	#3	2-00	L	#3 @48" LINKS	65
648															
649 MARK = SW2-2															
650									2	23	#5	8-00	H	#5 @12" DWL EF	384
651									2	23	#5	25-00		#5 @12" VERT EF	1199

Bid Date -

** ESTIMATING BAR LIST **

LINE	LA	EP	A/D	STRUCTURE	MULT	REQ	CODE	+	X	QTY	SZ/GR	LENGTH	B	COMMENT	LINE LB
652									2	23	#4	96-08		#4 @12" VERT EF	2970
653									2	103	#4	22-00		#4 @12" HOR EF	3027
654									2	103	#4	5-06	L	#4 @12" U-BAR ES	757
655									36	2	#5	4-00		2-#5 DIG	300
656										87	#3	2-00	L	#3 @48" LINKS	65
657															
658 MARK = SW2-3															
659									2	15	#5	8-00	H	#5 @12" DWL EF	250
660									2	15	#5	25-00		#5 @12" VERT EF	782
661									2	15	#4	96-08		#4 @12" VERT EF	1937
662									2	103	#4	15-00		#4 @12" HOR EF	2064
663									2	103	#4	5-06	L	#4 @12" U-BAR ES	757
664									4	2	#5	4-00		2-#5 DIG	33
665										87	#3	2-00	L	#3 @48" LINKS	65
666															
667 ELEVATOR PIT															
668 MARK = EL1-1															
669									2	11	#5	8-00	H	#5 @10" DWL EF	184
670									2	11	#5	25-08		#5 @10" VERT EF	589
671									2	10	#4	97-04		#4 @12" VERT EF	1300
672									2	105	#4	10-00		#4 @12" HOR EF	1403
673									2	105	#4	5-06	L	#4 @12" U-BAR ES	772
674										87	#3	2-00	L	#3 @48" LINKS	65
675															
676 MARK = EL1-2															
677									2	35	#5	8-00	H	#5 @10" DWL EF	584
678									2	35	#5	25-00		#5 @10" VERT EF	1825
679									2	30	#4	120-00		#4 @12" VERT EF	4810
680									2	123	#4	29-00		#4 @12" HOR EF	4766
681									2	123	#4	5-06	L	#4 @12" U-BAR ES	904
682									38	2	#5	4-00		2-#5 DIG	317

Bid Date -

** ESTIMATING BAR LIST **

LINE	LA	EP	A/D	STRUCTURE	MULT	REQ	CODE	+	X	QTY	SZ/GR	LENGTH	B	COMMENT	LINE LB
683										148	#3	2-00	L	#3 @48" LINKS	111
684 MARK = EL1-3															
685									2	11	#5	8-00	H	#5 @10" DWL EF	184
686									2	11	#5	25-08		#5 @10" VERT EF	589
687									2	10	#4	120-00		#4 @12" VERT EF	1603
688									2	123	#4	10-00		#4 @12" HOR EF	1643
689									2	123	#4	5-06	L	#4 @12" U-BAR ES	904
690										87	#3	2-00	L	#3 @48" LINKS	65
691															
692				CMU WALL	CMU WALL (LEVEL- 1 TO 9) (8-LOC)										
693 REF-SECTION (1&2/A5.61) & (2/A5.31)															
694 (17/S4.32) & (18/S4.32) (146 LFT)															
695					8					40	#5	13-02		#5 @48" VERT	4395
696					8				8	2	#5	13-02		2-#5 END VERT	1758
697					8	2			9	2	#5	20-00		2-#5 @48" BB	6008
698					8				9	2	#5	20-00		2-#5 BB TOP	3004
699															
700				UPPER LEVEL	UPPER LEVEL										
701 LEVEL-2 (S2.02)															
702 REF-SECTION (18/S4.33) 40 LFT															
703									2	3	#5	40-00		3-#5 CONT T&B	250
704						4			2	3	#5	6-00	H	3-#5 CONT T&B COR	150
705 REF-SECTION (4/S4.32) 74 LFT															
706									2	1	#5	40-00		1-#5 CONT	83
707										25	#4	6-06	L	#4 @24" TOP HOOK BAR	109
708										13	#4	16-06	L	#4 @24" TOP HOOK BAR	143
709 REF-SECTION (13/S4.33)															
710						4			2	2	#4	5-00		2-#4 T&B (4-LOC)	53
711									2	2	#4	6-00	L	2-#4 HAIRPIN (2-LOC)	16
712 REF-SECTION - 5/S4.31 & 10/S2.02R (580 LFT)															
713						16			2	2	#5	40-00		2-#5 CONT T&B	2670

Bid Date -

** ESTIMATING BAR LIST **

LINE	LA	EP	A/D	STRUCTURE	MULT	REQ	CODE	+	X	QTY	SZ/GR	LENGTH	B	COMMENT	LINE LB
714						15			2	2	#5	6-00	H	2-#5 CONT COR T&B	375
715										390	#4	6-06	H	#4 @18" DWL	1693
716 REF-SECTION (3/S4.10) (10-LOC)															
717									10	1	#4	6-00	L	1-#4 HAIRPIN BAR	40
718 REF-SECTION (12/S4.33) & 4/S4.31 (76 LFT)															
719									2	78	#4	5-00	L	#4 @12" DWL EF	521
720									2	78	#4	10-00		#4 @12" VERT EF	1042
721						2			2	11	#4	40-00		#4 @12" HOR EF	1176
722						3			2	11	#4	4-00	L	#4 @12" HOR COR EF	176
723 REF-SECTION (17/S4.32) (146 LFT)															
724										60	#6	5-00	H	#5 @48" CMU DWL	451
725 POST TENSIONED BEAMS															
726 MARK = PTBM-02-02 (28 LFT)															
727										2	#7	30-00	H	2-#7 TOP	123
728										4	#7	30-00	H	4-#7 BOT	245
729									2	2	#4	4-00	L	2-#4 ADDL STIRR ES	11
730									2	2	#4	1-06	L	2-#4 ADDL LINKKS ES	4
731										30	#4	4-00	L	#4 @12" STIRR	80
732										30	#4	1-06	L	#4 @12" LINKS TOP	30
733 MARK = PTBM-02-03 (17 LFT)															
734										2	#6	19-00	H	2-#6 TOP	57
735										2	#6	19-00	H	2-#6 BOT	57
736									2	2	#4	3-08	L	2-#4 ADDL STIRR ES	10
737									2	2	#4	1-06	L	2-#4 ADDL LINKKS ES	4
738										20	#4	3-08	L	#4 @10" STIRR	49
739										20	#4	1-06	L	#4 @10" LINKS TOP	20
740 MARK = PTBM-02-04 (22 LFT)															
741										2	#6	24-00	H	2-#6 TOP	72
742										2	#6	24-00	H	2-#6 BOT	72
743									2	2	#4	3-06	L	2-#4 ADDL STIRR ES	9
744									2	2	#4	1-06	L	2-#4 ADDL LINKKS ES	4

Bid Date -

** ESTIMATING BAR LIST **

LINE	LA	EP	A/D	STRUCTURE	MULT	REQ	CODE	+	X	QTY	SZ/GR	LENGTH	B	COMMENT	LINE LB
745										24	#4	3-06	L	#4 @12" STIRR	56
746										24	#4	1-06	L	#4 @12" LINKS TOP	24
747 LEVEL - 2 (MILD REINF.) (S2.02R)															
748									6	9	#4	6-08	L	9-#4 TOP	240
749									10	9	#4	9-00		9-#4 TOP	541
750									6	8	#4	9-00		8-#4 TOP	289
751										6	#4	5-08	L	6-#4 TOP	23
752										6	#4	4-08	L	6-#4 TOP	19
753										8	#4	7-01	L	8-#4 TOP	38
754									8	8	#4	6-08	L	8-#4 TOP	285
755										4	#4	9-00		4-#4 TOP	24
756									12	8	#4	10-00		8-#4 TOP	641
757										9	#4	11-00		9-#4 TOP	66
758										9	#4	10-00		9-#4 TOP	60
759										6	#4	11-00		6-#4 TOP	44
760									2	10	#4	9-00		10-#4 TOP	120
761									5	11	#4	9-00		11-#4 TOP	331
762										2	#4	12-00		2-#4 BOT	16
763										11	#4	6-00		11-#4 TOP	44
764										4	#4	12-00		4-#4 BOT	32
765										11	#4	13-00		11-#4 BOT	96
766										8	#4	5-08	L	8-#4 TOP	30
767										11	#4	5-08	L	11-#4 TOP	42
768										4	#4	11-00		4-#4 BOT	29
769										5	#4	12-00		5-#4 BOT	40
770										8	#6	9-00		8-#6 TOP	108
771										8	#6	5-00	H	8-#6 TOP	60
772										7	#4	5-08	L	7-#4 TOP	26
773									2	3	#6	12-00		3-#6 TOP	108
774										5	#4	17-05		5-#4 @12" BOT	58
775										5	#4	18-02	L	5-#4 @12" TOP	61

Bid Date -

** ESTIMATING BAR LIST **

LINE	LA	EP	A/D	STRUCTURE	MULT	REQ	CODE	+	X	QTY	SZ/GR	LENGTH	B	COMMENT	LINE LB
776										4	#4	10-02	L	#4 @12" BOT	27
777										10	#4	12-08	L	#4 @12" TOP	85
778										10	#4	11-00		#4 @12" BOT	73
779										2	#6	11-08	L	2-#6 @3" BOT	35
780										2	#6	11-08	L	2-#6 @3" TOP	35
781										5	#4	14-08	L	5-#4 @12" TOP	49
782										5	#4	13-04		5-#4 @12" BOT	45
783										8	#4	10-04	L	#4 @12" TOP	55
784										14	#4	4-08	L	#4 @12" TOP	44
785										3	#4	14-08		#4 @12" TOP	29
786										5	#4	14-08		5-#4 @12" BOT	49
787										8	#4	3-04	L	#4 @12" TOP	18
788									2	29	#4	4-08		#4 @12" TOP	181
789										5	#4	14-08		5-#4 @12" TOP	49
790										5	#4	14-08		5-#4 @12" BOT	49
791										5	#4	33-00		5-#4 @12" TOP	110
792										5	#4	33-00		5-#4 @12" BOT	110
793										5	#4	34-00		5-#4 @12" TOP	114
794										5	#4	34-00		5-#4 @12" BOT	114
795									2	6	#4	9-08	H	11-#6 TOP	77
796									2	7	#6	10-00		7-#6 TOP	210
797										11	#6	8-00		11-#6 TOP	132
798										10	#4	8-01	L	10-#4 TOP	54
799										10	#4	8-00		10-#4 TOP	53
800										10	#4	5-08	L	10-4 TOP	38
801										10	#4	8-00	L	10-#4 TOP	53
802										6	#4	7-08	L	6-#4 TOP	31
803										6	#4	5-08		6-#4 TOP	23
804									2	11	#6	8-00		11-#6 TOP	264
805									2	7	#6	10-00		7-#6 TOP	210
806									2	6	#4	5-08	L	6-#4 TOP	45

Bid Date -

** ESTIMATING BAR LIST **

LINE	LA	EP	A/D	STRUCTURE	MULT	REQ	CODE	+	X	QTY	SZ/GR	LENGTH	B	COMMENT	LINE LB
807										4	#4	11-05		4-#4 TOP	31
808										9	#6	9-00		9-#6 TOP	122
809									2	9	#6	4-08	H	9-#6 TOP	126
810										11	#6	11-00		11-#6 TOP	182
811										4	#6	18-00		4-#6 @3" BOT	108
812										5	#6	9-00		5-#6 @3" TOP	68
813										3	#6	9-00	H	3-#6 BOT	41
814										3	#6	12-00		3-#6 TOP	54
815										5	#4	12-00		#4 @12" TOP	40
816										5	#4	8-00	L	5-#4 @12" TOP	27
817										8	#4	6-08	L	8-#4 TOP	36
818										4	#4	4-08	L	4-#4 @12" TOP	12
819										2	#6	12-00		2-#6 BOT	36
820										8	#4	13-08	L	#4 @12" BOT	73
821										8	#4	13-08		#4 @12" TOP	73
822										4	#4	12-01	L	#4 @12" TOP	32
823										4	#4	8-09	L	#4 @12" BOT	23
824										3	#4	12-00		3-4 BOT	24
825										4	#4	6-08	L	4-#4 TOP	18
826										1	#6	12-00		#6 BOT	18
827										4	#4	8-08		4-#4 TOP	23
828										4	#4	40-00		4-#4 @12" TOP	107
829	SLAB OPENING														
830						3			4	1	#5	4-00		#5 T&B	50
831						3			2	2	#5	6-00		2-#5 @3" T&B	75
832						6			4	1	#5	3-00		#5 T&B	75
833						6			2	2	#5	6-06		2-#5 @3" T&B	163
834									4	1	#5	3-00		#5 T&B	13
835									2	2	#5	6-06		2-#5 @3" T&B	27
836									4	1	#5	3-00		#5 T&B	13
837									2	2	#5	8-04		2-#5 @3" T&B	35

Bid Date -

** ESTIMATING BAR LIST **

LINE	LA	EP	A/D	STRUCTURE	MULT	REQ	CODE	+	X	QTY	SZ/GR	LENGTH	B	COMMENT	LINE LB
838						7			4	1	#5	3-00		#5 T&B	88
839						7			2	2	#5	6-04		2-#5 @3" T&B	185
840															
841														LEVEL-3 (REF SHEET-S2.03)	
842														REF-SECTION (18/S4.33) 40 LFT	
843									2	3	#5	40-00		3-#5 CONT T&B	250
844						4			2	3	#5	6-00	H	3-#5 CONT T&B COR	150
845														REF-SECTION (13/S4.33)	
846						4			2	2	#4	5-00		2-#4 T&B (4-LOC)	53
847									2	2	#4	6-00	L	2-#4 HAIRPIN (2-LOC)	16
848														REF-SECTION - 5/S4.31 & 10/S2.02R (580 LFT)	
849						16			2	2	#5	40-00		2-#5 CONT T&B	2670
850						15			2	2	#5	6-00	H	2-#5 CONT COR T&B	375
851										390	#4	6-06	H	#4 @18" DWL	1693
852														REF-SECTION (3/S4.10) (10-LOC)	
853									10	1	#4	6-00	L	1-#4 HAIRPIN BAR	40
854														REF-SECTION (17/S4.32) (40 LFT)	
855										12	#6	5-00	H	#6 @48" CMU DWL	90
856														POST TENSIONED BEAMS	
857														MARK = PTBM-03-02 (28 LFT)	
858										4	#7	30-00	H	4-#7 TOP	245
859										4	#7	30-00	H	4-#7 BOT	245
860									2	2	#4	4-00	L	2-#4 ADDL STIRR ES	11
861									2	2	#4	1-06	L	2-#4 ADDL LINKKS ES	4
862										30	#4	4-00	L	#4 @12" STIRR	80
863										30	#4	1-06	L	#4 @12" LINKS TOP	30
864														MARK = PTBM-03-03 (22 LFT)	
865										2	#6	24-00	H	2-#6 TOP	72
866										2	#6	24-00	H	2-#6 BOT	72
867									2	2	#4	3-08	L	2-#4 ADDL STIRR ES	10
868									2	2	#4	1-06	L	2-#4 ADDL LINKKS ES	4

Bid Date -

**** ESTIMATING BAR LIST ****

LINE	LA	EP	A/D	STRUCTURE	MULT	REQ	CODE	+	X	QTY	SZ/GR	LENGTH	B	COMMENT	LINE LB
869										26	#4	3-08	L	#4 @10" STIRR	64
870										26	#4	1-06	L	#4 @10" LINKS TOP	26
871 MARK = PTBM-03-04 (22 LFT)															
872										2	#6	24-00	H	2-#6 TOP	72
873										2	#6	24-00	H	2-#6 BOT	72
874									2	2	#4	3-06	L	2-#4 ADDL STIRR ES	9
875									2	2	#4	1-06	L	2-#4 ADDL LINKKS ES	4
876										24	#4	3-06	L	#4 @12" STIRR	56
877										24	#4	1-06	L	#4 @12" LINKS TOP	24
878 REF-SECTION (9/S4.32) (80 LFT)															
879									2	82	#6	7-06	L	#4 @12" D/V EF	1847
880						2			2	2	#5	40-00		#4 @16" HOR EF	334
881 REF-SECTION (9/S4.32) (125 LFT)															
882										126	#4	3-09	L	#4 @12" D/V	316
883									2	2	#4	40-00		#4 @12" HOR	107
884									2	2	#4	4-00	L	#4 @12" HOR COR	11
885 LEVEL-3 ADDL REINFORCEMENT (REF SHEET S2.03R)															
886										6	#4	5-00	L	6-#4 TOP HOOK	20
887										6	#4	7-00	L	6-#4 TOP HOOK	28
888										6	#4	8-00		6-#4 TOP	32
889										8	#4	5-00	L	6-#4 TOP HOOK	27
890									2	4	#4	40-00		4-#4 @12" ON SIDE BM	214
891										3	#6	11-00	H	3-#6 @12" TOP HOOK	50
892										10	#4	13-00	L	#4 @12" BOT HOOK	87
893										11	#4	13-00	L	#4 @12" TOP HOOK	96
894										5	#4	10-06		#4 @12" TOP HOOK	35
895										6	#4	13-00		#4 @12" TOP HOOK	52
896										8	#4	10-00		8-#4 TOP	53
897										8	#4	10-00		8-#4 TOP	53
898										14	#4	5-00	L	#4 @12" TOP HOOK	47
899										4	#4	9-00	L	4-#4 TOP HOOK	24

Bid Date -

** ESTIMATING BAR LIST **

LINE	LA	EP	A/D	STRUCTURE	MULT	REQ	CODE	+	X	QTY	SZ/GR	LENGTH	B	COMMENT	LINE LB
900										4	#4	7-00	L	4-#4 TOP HOOK	19
901										3	#4	12-00		3-#4 @12" BOT	24
902										8	#4	10-00		8-#4 TOP	53
903										8	#4	10-00		8-#4 TOP	53
904										8	#4	10-00		8-#4 TOP	53
905										8	#4	7-00	L	8-#4 TOP HOOK	37
906										8	#4	7-00	L	8-#4 TOP HOOK	37
907										8	#4	10-00		8-#4 TOP	53
908						2			2	8	#4	10-00		8-#4 EW TOP (2-LOC)	214
909										8	#4	6-07	L	8-#4 TOP HOOK	35
910										8	#4	10-00		8-#4 TOP	53
911									2	8	#4	12-00		8-#4 @12" BOT(2-LOC)	128
912										5	#4	15-00	L	5-#4 @12" TOP HOOK	50
913										5	#4	13-00		5-#4 @12" BOT	43
914										15	#4	6-02	L	#4 @12" TOP HOOK	62
915									2	2	#6	11-09		2-#6 @3" T&B	71
916									2	3	#6	12-00		3-#6 @3" T&B	108
917										12	#4	12-00	L	#4 @12" TOP HOOK	96
918										12	#4	12-00	L	#4 @12" BOT HOOK	96
919										5	#4	17-05		5-#4 @12" BOT	58
920										5	#4	18-03	H	5-#4 @12" TOP HOOK	61
921										2	#4	13-00		2-#4 BOT	17
922									3	6	#6	6-00	H	6-#6 TOP HOOK(3-LOC)	162
923									3	6	#6	9-00		6-#6 TOP (3-LOC)	243
924										8	#4	12-00		8-#4 @12" BOT	64
925										7	#4	11-00		7-#4 @12" BOT(2-LOC)	51
926										2	#4	11-00		2-#4 BOT	15
927										12	#4	19-00		12-#4 BOT	152
928										10	#4	9-02	H	10-#4 TOP HOOK	61
929										5	#4	36-00	H	5-#4 @12" TOP HOOK	120
930										5	#4	35-00		5-#4 @12" BOT	117

Bid Date -

** ESTIMATING BAR LIST **

LINE	LA	EP	A/D	STRUCTURE	MULT	REQ	CODE	+	X	QTY	SZ/GR	LENGTH	B	COMMENT	LINE LB
931									2	5	#4	14-09		5-#4 @12" T&B	99
932										12	#4	5-00	L	#4 @12" TOP HOOK	40
933										5	#4	35-00	L	5-#4 @12" TOP HOOK	117
934										5	#4	34-00		5-#4 @12" BOT	114
935										5	#4	14-08		5-#4 @12" TOP	49
936										20	#4	5-00	L	#4 @12" TOP HOOK	67
937										10	#4	4-02	L	#4 @12" TOP HOOK	28
938										5	#4	14-09		5-#4 @12" BOT	49
939										9	#4	11-08	L	#4 @12" BOT HOOK	70
940										9	#4	11-08	L	#4 @12" TOP HOOK	70
941									2	6	#6	9-00		6-#6 TOP EW	162
942						2			2	8	#6	9-00		8-#6 EW TOP (2-LOC)	433
943										7	#4	13-00		7-#4 BOT	61
944									2	8	#4	10-00		8-#4 EW TOP	107
945										8	#4	10-00		8-#4 TOP	53
946									2	8	#4	7-00	L	8-#4 TOP HOOK(2-LOC)	75
947									2	8	#4	7-00	L	8-#4 EW TOP HOOK	75
948										8	#4	10-00		8-#4 TOP	53
949										8	#4	7-00	L	8-#4 TOP HOOK	37
950									2	6	#6	7-00	H	6-#6 EW TOP HOOK	126
951										4	#4	9-00		4-#4 TOP	24
952										8	#4	7-00	L	8-#4 TOP HOOK	37
953										8	#4	9-00		8-#4 TOP	48
954										6	#4	5-00	H	6-#4 TOP HOOK	20
955										6	#4	6-00	H	6-#4 TOP HOOK	24
956									2	10	#4	9-00		10-#4 EW TOP	120
957									2	8	#4	9-00		8-#4 TOP EW	96
958										9	#4	7-00	L	9-#4 TOP HOOK	42
959										9	#4	9-00		9-#4 TOP	54
960										9	#4	7-00	L	9-#4 TOP HOOK	42
961										9	#4	9-00		9-#4 TOP	54

Bid Date -

** ESTIMATING BAR LIST **

LINE	LA	EP	A/D	STRUCTURE	MULT	REQ	CODE	+	X	QTY	SZ/GR	LENGTH	B	COMMENT	LINE LB
962										9	#4	7-00	L	9-#4 TOP HOOK	42
963										9	#4	9-00		9-#4 TOP	54
964										9	#4	7-00	L	9-#4 TOP HOOK	42
965										9	#4	7-00		9-#4 TOP HOOK	42
966										9	#4	7-00		9-#4 TOP HOOK	42
967						4			2	9	#4	9-00		9-#4 TOP EW (4-LOC)	433
968										9	#4	11-00		9-#4 TOP	66
969										8	#4	10-00		8-#4 TOP	53
970									2	8	#4	10-00		8-#4 TOP EW	107
971									2	4	#4	38-00		4-#4 @12" TOP ES BM	203
972									2	4	#4	27-00		4-#4 @12" TOP ES BM	144
973 OPENING ADDL BARS (17-LOC)															
974					17	2			2	2	#5	9-00		2-#5 @3" T&B ES	1277
975					17	2			2	2	#5	7-00		2-#5 @3" T&B ES	993
976					17	4			2	1	#5	4-00		1-#5 DIG. BAR T&B	567
977															
978 LEVEL-4 TO 8 (S2.04) (5-LOC.)															
979 REF-SECTION - 5/S4.31 (634 LFT)															
980					5	17			2	2	#5	40-00		2-#5 CONT T&B	14185
981					5	15			2	2	#5	6-00	H	2-#5 CONT COR T&B	1877
982					5					430	#4	6-06	H	#4 @18" DWL	9335
983 REF-SECTION (18/S4.33) 50 LFT															
984					5				2	3	#5	40-00		3-#5 CONT T&B	1252
985 REF-SECTION (17/S4.32) (156 LFT)															
986					5					60	#6	5-00	H	#5 @48" CMU DWL	2253
987 POST TENSIONED BEAMS															
988 MARK = PTBM-04-02 (28 LFT)															
989					5					4	#7	30-00	H	4-#7 TOP	1226
990					5					4	#7	30-00	H	4-#7 BOT	1226
991					5				2	2	#4	4-00	L	2-#4 ADDL STIRR ES	53
992					5				2	2	#4	1-06	L	2-#4 ADDL LINKKS ES	20

Bid Date -

** ESTIMATING BAR LIST **

LINE	LA	EP	A/D	STRUCTURE	MULT	REQ	CODE	+	X	QTY	SZ/GR	LENGTH	B	COMMENT	LINE LB
993					5					30	#4	4-00	L	#4 @12" STIRR	401
994					5					30	#4	1-06	L	#4 @12" LINKS TOP	150
995 MARK = PTBM-04-04 (22 LFT)															
996					5					20	#4	1-06	L	#4 @10" LINKS TOP	100
997					5					2	#6	24-00	H	2-#6 TOP	360
998					5					2	#6	24-00	H	2-#6 BOT	360
999					5				2	2	#4	3-06	L	2-#4 ADDL STIRR ES	47
1000					5				2	2	#4	1-06	L	2-#4 ADDL LINKKS ES	20
1001					5					24	#4	3-06	L	#4 @12" STIRR	281
1002					5					24	#4	1-06	L	#4 @12" LINKS TOP	120
1003 MARK = PTBM-04-03 (20 LFT)															
1004					5					2	#6	20-00	H	2-#6 TOP	300
1005					5					2	#6	20-00	H	2-#6 BOT	300
1006					5				2	2	#4	3-08	L	2-#4 ADDL STIRR ES	49
1007					5				2	2	#4	1-06	L	2-#4 ADDL LINKKS ES	20
1008					5					24	#4	3-08	L	#4 @10" STIRR	294
1009					5					24	#4	1-06	L	#4 @10" LINKS TOP	120
1010 LEVEL - 4 TO 8 (MILD REINF.) (S2.04R)															
1011					5				6	9	#4	6-08	L	9-#4 TOP	1202
1012					5				10	9	#4	9-00		9-#4 TOP	2705
1013					5				5	8	#4	9-00		8-#4 TOP	1202
1014					5					6	#4	4-08	L	6-#4 TOP	94
1015					5					6	#4	5-08	L	6-#4 TOP	114
1016					5				6	8	#4	6-08	L	8-#4 TOP	1069
1017					5					4	#4	9-00		4-#4 TOP	120
1018					5					10	#4	10-00		10-#4 TOP	334
1019					5				6	8	#4	10-00		8-#4 TOP	1603
1020					5					9	#4	11-00		9-#4 TOP	331
1021					5				2	9	#4	12-02	L	9-#4 TOP	731
1022					5				2	8	#4	10-00	L	#4 @12" TOP	534
1023					5					10	#4	12-00		#4 @12" TOP	401

Bid Date -

** ESTIMATING BAR LIST **

LINE	LA	EP	A/D	STRUCTURE	MULT	REQ	CODE	+	X	QTY	SZ/GR	LENGTH	B	COMMENT	LINE LB
1024					5					10	#4	11-00		#4 @12" TOP	367
1025					5					5	#4	17-05		5-#4 @12" BOT	291
1026					5					5	#4	18-01		5-#4 @12" TOP	302
1027					5					3	#6	12-00		3-#6 TOP	270
1028					5					3	#6	12-00		3-#6 BOT	270
1029					5					3	#4	8-00	L	3-#4 @12" TOP	80
1030					5					2	#6	11-10		2-#6 @3" TOP	178
1031					5					2	#6	11-10		2-#6 @3" BOT	178
1032					5					5	#4	14-09	L	5-#4 @12" TOP	246
1033					5					5	#4	13-05	L	5-#4 @12" BOT	224
1034					5					4	#4	4-08	L	#4 @12" TOP	62
1035					5				3	6	#4	4-08	L	6-#4 TOP	281
1036					5					6	#4	5-08	L	6-#4 TOP	114
1037					5				2	6	#4	8-00		6-#4 TOP	321
1038					5					10	#4	8-08	L	10-#4 TOP	289
1039					5					10	#4	4-08	L	10-#4 TOP	156
1040					5					29	#4	4-08	L	#4 @12" TOP	452
1041					5					8	#4	6-08	L	8-#4 TOP	178
1042					5				7	8	#4	10-00		8-#4 TOP	1870
1043					5				2	8	#4	6-08	L	8-#4 TOP	356
1044					5				2	6	#4	12-00		6-#4 BOT	481
1045					5				2	6	#4	6-08	L	6-#4 BOT	267
1046					5					6	#4	4-08	L	6-#4 BOT	94
1047					5					5	#4	12-08	L	#4 @12" TOP	212
1048					5				2	3	#6	10-00		3-#6 @12" TOP	451
1049					5				2	5	#4	8-01	L	5-#4 @12" TOP	270
1050					5					9	#4	14-04	L	#4 @12" BOT	431
1051					5					9	#4	14-04	L	#4 @12" TOP	431
1052					5					3	#4	12-00		3-#4 BOT	120
1053					5					4	#4	6-08	L	4-#4 TOP	89
1054					5					4	#4	8-08	L	4-#4 TOP	116

Bid Date -

** ESTIMATING BAR LIST **

LINE	LA	EP	A/D	STRUCTURE	MULT	REQ	CODE	+	X	QTY	SZ/GR	LENGTH	B	COMMENT	LINE LB
1055					5					4	#4	4-08	L	4-#4 @12" TOP	62
1056					5				3	8	#4	10-00		8-#4 TOP	802
1057					5					2	#6	12-00		2-#6 BOT	180
1058					5				4	8	#4	6-08	L	8-#4 TOP	713
1059					5				2	5	#4	34-00		5-#4 @12" BOT	1136
1060					5				2	5	#4	34-08		5-#4 @12" TOP	1158
1061					5					5	#4	14-08		5-#4 @12" TOP	245
1062					5				2	5	#4	14-08		5-#4 @12" BOT	490
1063					5				2	8	#4	4-08	L	#4 @12" TOP	249
1064					5					8	#4	3-06		#4 @12" TOP	94
1065 SLAB OPENING															
1066					5	15			4	1	#5	3-00		#5 T&B	939
1067					5	13			2	2	#5	6-04		2-#5 @3" T&B	1717
1068					5	13			2	2	#5	11-04		2-#5 @3" T&B	3073
1069					5					4	#4	40-00		4-#4 @12" TOP	534
1070					5					4	#4	25-00		4-#4 @12" TOP	334
1071					5					4	#4	30-00		4-#4 @12" TOP	401
1072															
1073 LEVEL-9															
1074 REF-SECTION (18/S4.33) 40 LFT															
1075									2	3	#5	40-00		3-#5 CONT T&B	250
1076						4			2	3	#5	6-00	H	3-#5 CONT T&B COR	150
1077 REF-SECTION (13/S4.33)															
1078						4			2	2	#4	5-00		2-#4 T&B (4-LOC)	53
1079									2	2	#4	6-00	L	2-#4 HAIRPIN (2-LOC)	16
1080 REF-SECTION - 5/S4.31 & 1/S2.09 (315 LFT)															
1081						9			2	2	#5	40-00		2-#5 CONT T&B	1502
1082						12			2	2	#5	6-00	H	2-#5 CONT COR T&B	300
1083										215	#4	6-06	H	#4 @18" DWL	934
1084															
1085 REF-SECTION (20/S4.33)															

Bid Date -

**** ESTIMATING BAR LIST ****

LINE	LA	EP	A/D	STRUCTURE	MULT	REQ	CODE	+	X	QTY	SZ/GR	LENGTH	B	COMMENT	LINE LB
1086	5 1/4" THICK SLAB ON DECK														
1087	MESH TYPE = 6x6-W1.4xW1.4 WWR														
1088	SHEET SIZE = 12'-6" x 8'-0"														
1089	AREA = 90 SQ.FT														
1090	NO.OF SHEETS = 1 NO														
1091															
1092	REF-SECTION (20/S4.33) 40 LFT														
1093										1	#4	40-00		1-#4 CONT	27
1094										42	#4	4-00	L	#4 @12" DWL	112
1095									4	1	#4	4-10	L	1-#4 COR	13
1096	REF-SECTION (14/S4.32) 265 LFT														
1097									2	268	#4	12-04	L	#4 @12" D/V EF	4416
1098						8			2	11	#4	40-00		#4 @12" HOR EF	4703
1099						10			2	11	#4	4-10	L	#4 @12" COR EF	710
1100	REF-SECTION (4/S4.33) 202 LFT														
1101						7			2	1	#3	40-00		1-#3 T&B	211
1102										105	#3	5-00	L	#3 @24" DWL	197
1103						10			2	1	#3	4-00	L	1-#3 COR T&B	30
1104															
1105	POST TENSIONED BEAMS														
1106	MARK = PTBM-09-05 (10 LFT)														
1107										4	#7	15-00	H	4-#7 TOP	123
1108										4	#7	15-00	H	4-#7 BOT	123
1109									2	2	#4	7-06	L	2-#4 ADDL STIRR ES	20
1110									2	2	#4	1-06	L	2-#4 ADDL LINKKS ES	4
1111										12	#4	7-06	L	#4 @12" STIRR	60
1112										12	#4	1-06	L	#4 @12" LINKS TOP	12
1113	MARK = PTBM-09-02 (22 LFT)														
1114										4	#7	24-00	H	4-#7 TOP	196
1115										4	#7	24-00	H	4-#7 BOT	196
1116									2	2	#4	4-06	L	2-#4 ADDL STIRR ES	12

Bid Date -

** ESTIMATING BAR LIST **

LINE	LA	EP	A/D	STRUCTURE	MULT	REQ	CODE	+	X	QTY	SZ/GR	LENGTH	B	COMMENT	LINE LB
1117									2	2	#4	1-06	L	2-#4 ADDL LINKKS ES	4
1118										26	#4	4-06	L	#4 @10" STIRR	78
1119										26	#4	1-06	L	#4 @10" LINKS TOP	26
1120 MARK = PTBM-09-01 (16 LFT)															
1121										2	#7	19-00	H	2-#7 TOP	78
1122										2	#7	19-00	H	2-#7 BOT	78
1123									2	2	#4	4-04	L	2-#4 ADDL STIRR ES	12
1124									2	2	#4	1-06	L	2-#4 ADDL LINKKS ES	4
1125										18	#4	4-04	L	#4 @12" STIRR	52
1126										18	#4	1-06	L	#4 @12" LINKS TOP	18
1127										6	#4	40-00		6-#4 ADDL	160
1128															
1129 LEVEL-9 (MILD REINF.) (S2.09R)															
1130									3	5	#5	6-08	H	5-#5 TOP	104
1131									3	9	#5	6-08	H	9-#5 TOP	188
1132									3	9	#5	9-00		9-#5 TOP	253
1133									6	6	#6	9-00		6-#6 TOP	487
1134										5	#5	5-08	H	5-#5 TOP	30
1135										5	#5	4-08	H	5-#5 TOP	24
1136										5	#5	9-00		5-#5 TOP	47
1137										5	#4	17-04		5-#4 @12" BOT	58
1138										8	#4	17-04		8-#4 @12" TOP	93
1139										11	#4	9-08	L	#4 @12" TOP	71
1140										11	#4	9-08	L	#4 @12" BOT	71
1141										9	#4	10-10	L	#4 @12" BOT	65
1142										3	#4	8-08	L	3-#4 @12" TOP	17
1143										3	#6	12-00		3-#6 BOT	54
1144										5	#4	13-00		5-#4 @12" BOT	43
1145										8	#4	14-08	L	8-#4 @12" TOP	78
1146										13	#4	4-08	L	#4 @12" TOP	41
1147										6	#5	14-00		6-#5 BOT	88

Bid Date -

** ESTIMATING BAR LIST **

LINE	LA	EP	A/D	STRUCTURE	MULT	REQ	CODE	+	X	QTY	SZ/GR	LENGTH	B	COMMENT	LINE LB
1148										5	#5	5-08	L	5-#5 TOP	30
1149										2	#4	5-08	L	2-#4 @12" TOP	8
1150										5	#5	5-08	H	5-#5 TOP	30
1151										6	#5	5-08	H	6-#5 TOP	35
1152										6	#5	8-00		6-#5 TOP	50
1153										2	#6	11-10		2-#6 @3" TOP	36
1154										2	#6	11-10		2-#6 @3" BOT	36
1155									4	9	#5	9-00		9-#5 TOP	338
1156									2	9	#5	11-08	H	9-#5 TOP	219
1157										7	#6	9-00		7-#6 TOP	95
1158										7	#6	7-08		7-#6 TOP	81
1159										6	#6	6-08	H	6-#6 TOP	60
1160										6	#6	9-00		6-#6 TOP	81
1161									4	5	#6	6-08	H	5-#6 TOP	200
1162										4	#6	9-00		4-#6 TOP	54
1163										5	#6	7-00		5-#6 TOP	53
1164									3	5	#6	6-08	H	5-#6 TOP	150
1165										6	#4	10-00		6-#4 BOT	40
1166										6	#4	10-00		6-#4 TOP	40
1167									18	6	#6	10-00		6-#6 TOP	1622
1168									4	6	#6	6-08	H	6-#6 TOP	240
1169									4	10	#6	10-00		10-#6 TOP	601
1170										10	#6	6-08	H	10-#6 TOP	100
1171										10	#6	10-00		10-#6 TOP	150
1172										4	#6	8-00		4-#6 TOP	48
1173										2	#6	6-08		2-#6 TOP	20
1174										5	#6	7-02		5-#6 TOP	54
1175										25	#4	13-10	L	#4 @12" TOP	231
1176										25	#4	13-10	L	#4 @12" BOT	231
1177										12	#4	26-01	L	#4 @12" TOP	209
1178										12	#4	25-05	L	#4 @12" BOT	204

Bid Date -

** ESTIMATING BAR LIST **

LINE	LA	EP	A/D	STRUCTURE	MULT	REQ	CODE	+	X	QTY	SZ/GR	LENGTH	B	COMMENT	LINE LB
1179										6	#4	7-00		6-#4 TOP	28
1180										6	#4	7-00		6-#4 BOT	28
1181										6	#4	10-00		6-#4 BOT	40
1182										6	#4	10-00		6-#4 TOP	40
1183										5	#6	8-00		5-#6 TOP	60
1184										5	#6	8-08	H	5-#6 TOP	65
1185										5	#6	4-08		5-#6 TOP	35
1186									2	5	#4	33-04		5-#4 @12" TOP	223
1187									2	5	#4	33-04		5-#4 @12" BOT	223
1188										5	#4	14-08		5-#4 @12" TOP	49
1189										5	#4	14-08		5-#4 @12" BOT	49
1190										10	#4	4-08		10-#4 @12" TOP	31
1191										31	#4	4-08		#4 @12" TOP	97
1192										10	#4	8-00		#4 @12" BOT	53
1193										6	#4	9-00		#4 @12" BOT	36
1194															
1195	LEVEL-10 REF. (1/S2.10)														
1196	REF-SECTION 4/S4.31 (550 LFT)														
1197									2	555	#4	5-00	L	#4 @12" DWL EF	3707
1198									2	555	#4	10-00		#4 @12" VERT EF	7415
1199						2			2	14	#4	40-00		#4 @12" HOR EF	1496
1200						3			2	19	#4	4-00	L	#4 @12" HOR COR EF	305
1201	REF-SECTION (3/S4.10) (1-LOC.)														
1202										1	#4	6-00	L	1- #4 HAIRPIN	4
1203	POST TENSIONED BEAMS														
1204	MARK = PTBM-10-01 (90 LFT)														
1205									3	9	#7	40-00	H	9-#7 TOP	2208
1206									4	6	#7	30-00		6-#7 BOT	1472
1207										15	#5	10-00	H	15-#5 @5" ADDL STIRR	156
1208										2	#5	10-00	H	2-#5 @2" ADDL STIRR	21
1209										130	#5	10-00	H	#5 @8" STIRR	1356

Bid Date -

** ESTIMATING BAR LIST **

LINE	LA	EP	A/D	STRUCTURE	MULT	REQ	CODE	+	X	QTY	SZ/GR	LENGTH	B	COMMENT	LINE LB
1210 MARK = PTBM-10-02 (29 LFT)															
1211										2	#7	30-00	H	2-#7 TOP	123
1212										2	#7	30-00		2-#7 BOT	123
1213										2	#4	5-00	L	2-#4 ADDL STIRR ES	7
1214										2	#4	3-00	L	2-#4 ADDL LINKKS ES	4
1215										45	#4	5-00	L	#4 @9" STIRR	150
1216										45	#4	3-00	L	#4 @9" LINKS TOP	90
1217 MARK = PTBM-10-03 (30 LFT)															
1218										3	#7	30-00	H	3-#7 TOP	184
1219										3	#7	30-00		3-#7 BOT	184
1220										2	#4	8-00	L	2-#4 ADDL STIRR ES	11
1221										2	#4	3-00	L	2-#4 ADDL LINKKS ES	4
1222										30	#4	8-00	L	#4 @12" STIRR	160
1223										30	#4	3-00	L	#4 @12" LINKS TOP	60
1224 MARK = PTBM-10-04 (10 LFT)															
1225										2	#7	30-00	H	2-#7 TOP	123
1226										2	#7	30-00		2-#7 BOT	123
1227										2	#4	6-00	L	2-#4 ADDL STIRR ES	8
1228										2	#4	4-00	L	2-#4 ADDL LINKKS ES	5
1229										30	#4	6-00	L	#4 @12" STIRR	120
1230										30	#4	4-00	L	#4 @12" LINKS TOP	80
1231 LEVEL-10 ADDL REINFORCEMENT REF. (1/S2.10R)															
1232										14	#4	24-00		14-#4 @12" BOT	224
1233										14	#5	25-00	H	14-#5 @12" TOP	365
1234										25	#4	13-00		25-#4 @12" BOT	217
1235										25	#5	13-00	H	25-#5 @12" TOP	339
1236									2	5	#5	7-03	H	5-#5 TOP HOOK	76
1237										6	#4	6-02	L	6-#4 TOP HOOK	25
1238										3	#5	40-00		3- #5 @6" TOP	125
1239										6	#5	7-08	H	6- #5 @6" TOP HOOK	48
1240										54	#5	10-00	H	#5 @12" TOP HOOK	563

Bid Date -

** ESTIMATING BAR LIST **

LINE	LA	EP	A/D	STRUCTURE	MULT	REQ	CODE	+	X	QTY	SZ/GR	LENGTH	B	COMMENT	LINE LB
1241										39	#5	20-00	H	#5 @8" TOP HOOK	814
1242										83	#4	15-05		#4 @12" BOT	855
1243										9	#4	28-00		#4 @12" BOT	168
1244										9	#5	29-00	H	#5 @12" TOP	272
1245										5	#5	9-00		5-#5 @12" TOP	47
1246									7	7	#5	8-00	H	7-#5 TOP	409
1247									7	7	#5	9-00		7-#5 TOP	460
1248									4	5	#5	9-00		5-#5 TOP	188
1249									2	5	#4	26-00		5-#4 @12" BOT	174
1250									2	5	#4	30-00	L	5-#4 @12" TOP	200
1251									2	30	#4	5-00	L	#4 @12" TOP	200
1252										11	#4	14-00		#4 @12" BOT	103
1253										11	#4	14-00		#5 @12" TOP	103
1254										10	#5	11-00	H	10-#5 @18" TOP	115
1255										5	#5	7-00	H	5-#5 @12" TOP	37
1256										8	#5	9-00	H	8-#5 TOP	75
1257										4	#5	5-00	H	4-#5 TOP	21
1258									2	5	#5	7-00	H	5-#5 TOP	73
1259									2	5	#5	5-00	H	5-#5 TOP	52
1260										3	#5	10-00		3-#5 TOP	31
1261										7	#5	40-00		7-#5 TOP	292
1262									4	2	#5	5-00		2-#5 TOP	42
1263															
1264	LEVEL-11														
1265	REF-SECTION (4/S4.31) (291 LFT) (10-9 HT)														
1266						2			8	12	#4	40-00		#4 @12" HOR EF	5130
1267									2	295	#4	12-01	L	#4 @12" VERT EF	4762
1268	POST TENSIONED BEAMS														
1269	MARK = PTBM-11-03 (33 LFT)														
1270										5	#7	40-00	H	5-#7 TOP	409
1271										3	#7	40-00	H	3-#7 BOT	245

Bid Date -

** ESTIMATING BAR LIST **

LINE	LA	EP	A/D	STRUCTURE	MULT	REQ	CODE	+	X	QTY	SZ/GR	LENGTH	B	COMMENT	LINE LB
1272										38	#4	7-08	L	#4 @12" STIRR	195
1273 LEVEL-11 ADDL REINFORCEMENT															
1274 REF-SECTION (5/S4.31) (291 LFT)															
1275						2			8	2	#5	40-00		2-#5 CONT T&B	1335
1276										200	#4	6-08	L	#4 @18" HOOK	891
1277 LEVEL-11 ADDL REINFORCEMENT (REF SHEET S2.11R)															
1278									2	5	#4	6-09	L	5-#4 HOOK (2-LOC.)	45
1279									2	6	#4	6-08		6-#4 HOOK (2-LOC.)	53
1280										6	#4	7-03		6-#4 ADDL BAR	29
1281										6	#4	11-08	L	6-#4 HOOK	47
1282										4	#4	45-00	L	4 @12" HOOK	120
1283										10	#4	9-00		10-#4 ADDL BAR	60
1284										10	#4	9-08	L	10-#4 HOOK	65
1285									2	10	#4	12-00		10-#4 ADDL(2-LOC.)	160
1286										10	#4	13-00		10-#4 ADDL	87
1287										10	#4	11-08	L	10-#4 HOOK	78
1288									4	8	#4	12-04	L	8-#4 TOP	264
1289										10	#4	14-00		10-#4 TOP	94
1290										10	#4	14-04	L	10-#4 TOP	96
1291										8	#4	7-04	L	8-#4 TOP	39
1292										8	#4	7-02		8-#4 TOP	38
1293										14	#4	12-05		#4 @12" BOT	116
1294										12	#4	14-04		#4 @12" BOT	115
1295										18	#4	14-04		#4 @12" BOT	172
1296										21	#4	13-06	L	#4 @8" TOP	189
1297									3	10	#4	12-00		10-#4 TOP	240
1298										10	#4	13-04	L	10-#4 TOP	89
1299										10	#4	10-04	L	10-#4 TOP	69
1300										10	#4	9-02		10-#4 TOP	61
1301									3	10	#4	12-02		10-#4 TOP	244
1302										10	#4	12-04	L	10-#4 TOP	82

Bid Date -

** ESTIMATING BAR LIST **

LINE	LA	EP	A/D	STRUCTURE	MULT	REQ	CODE	+	X	QTY	SZ/GR	LENGTH	B	COMMENT	LINE LB
1303															
1304				SITWORK			SITWORK								
1305				BOLLARD AT SLAB											
1306				REF.-(20/S3.01)(2 -LOC)											
1307						2				4	#6	2-06		4-#6 VERT	30
1308						2				3	#3	5-06	L	#3 @8" TIES	12
1309						2		2		3	#3	5-06	L	3-#3 TIES @TOP	25
1310															
1311				TRASH COMPACTOR											
1312				REF.-(A0.03 & S1.01)(1710 SQ.FT)											
1313										95	#4	40-00		#4 @12" EW	2538
1314															
1315				AIR ENTRAINED											
1316				REF.-(A0.03 & S1.01)											
1317				5" THICK SLAB ON GRADE											
1318				MESH TYPE = 6x6-W2.9xW2.9 WWR											
1319				SHEET SIZE = 12'-6" x 8'-0"											
1320				AREA = 2850 SQ.FT											
1321				NO.OF SHEETS = 33 NOS											
1322															
1323															

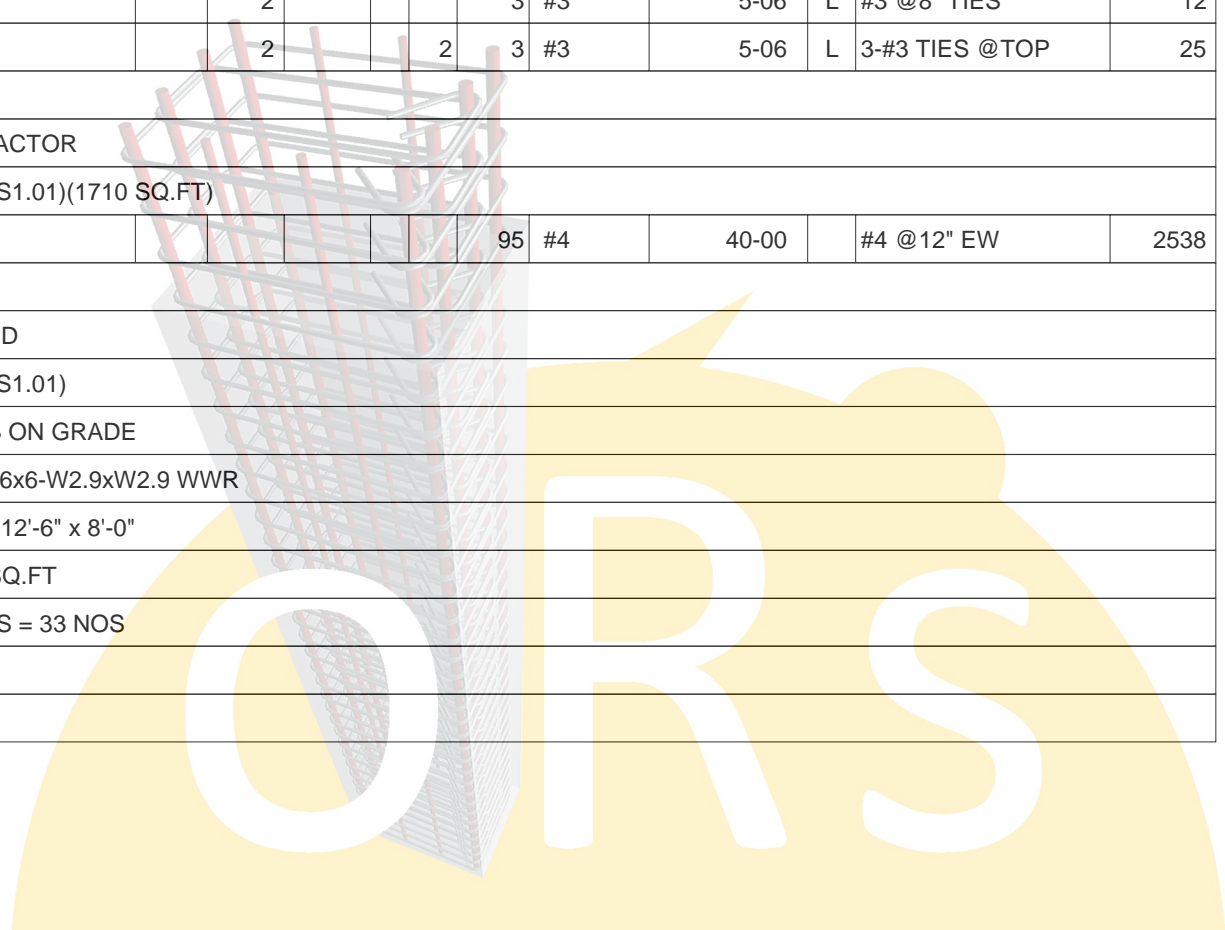

Bid Date -

**** TOTALS PAGE (LBS) ****

SPREAD FTG	STRUCTURE TOTAL	STRAIGHT	LIGHT BENT	HEAVY BENT	STOCK/MILL					
SIZE	%	Weight	%	Weight	%	Weight	%	Weight	%	Weight
#4 Gr 60	100	155		100	155					
#5 Gr 60	100	297	100	297						
#6 Gr 60	100	589	100	589						
#7 Gr 60	100	2,670	100	2,670						
#8 Gr 60	100	7,380	100	7,380						
Average Lbs per Linear Feet = 2.2274						Average Rebar Size = 7.52				
Total 5.6 Tons	100	11,091	99	10,936	1	155				

MAT FOOTING	STRUCTURE TOTAL	STRAIGHT	LIGHT BENT	HEAVY BENT	STOCK/MILL					
SIZE	%	Weight	%	Weight	%	Weight	%	Weight	%	Weight
#5 Gr 60	100	2,494			100	2,494				
#7 Gr 60	100	15,044	12	1,799	88	13,245				
#8 Gr 60	100	30,649	100	30,649						
Average Lbs per Linear Feet = 2.2697						Average Rebar Size = 7.53				
Total 24.1 Tons	100	48,187	67	32,448	33	15,739				

CONC. COLUMN	STRUCTURE TOTAL	STRAIGHT	LIGHT BENT	HEAVY BENT	STOCK/MILL					
SIZE	%	Weight	%	Weight	%	Weight	%	Weight	%	Weight
#3 Gr 60	100	51,369		100	51,369					
#6 Gr 60	100	1,123	56	627	44	496				
#7 Gr 60	100	126,731	93	117,961	7	8,770				
#8 Gr 60	100	4,049			100	4,049				
Average Lbs per Linear Feet = .9123						Average Rebar Size = 5.89				
Total 91.7 Tons	100	183,272	65	118,588	28	51,369	7	13,315		

Bid Date -

** TOTALS PAGE (LBS) **

CONTINUES FT&STRUCTURE TOTAL		----- STRAIGHT -----		LIGHT BENT -----		HEAVY BENT -----		STOCK/MILL -----		
SIZE	%	Weight	%	Weight	%	Weight	%	Weight	%	Weight
#4 Gr 60	100	3,215	17	544	43	1,388			40	1,283
Average Lbs per Linear Feet = .6680						Average Rebar Size = 4.00				
Total 1.7 Tons	100	3,215	17	544	43	1,388			40	1,283

CONC.WALL STRUCTURE TOTAL		----- STRAIGHT -----		LIGHT BENT -----		HEAVY BENT -----		STOCK/MILL -----		
SIZE	%	Weight	%	Weight	%	Weight	%	Weight	%	Weight
#4 Gr 60	100	2,123	43	908	17	360			40	855
Average Lbs per Linear Feet = .6680						Average Rebar Size = 4.00				
Total 1.1 Tons	100	2,123	43	908	17	360			40	855

SOG STRUCTURE TOTAL		----- STRAIGHT -----		LIGHT BENT -----		HEAVY BENT -----		STOCK/MILL -----		
SIZE	%	Weight	%	Weight	%	Weight	%	Weight	%	Weight
#3 Gr 60	100	179	12	21	88	158				
#4 Gr 60	100	4,490	3	122	43	1,909			55	2,459
#5 Gr 60	100	3,997	81	3,224			19	773		
Average Lbs per Linear Feet = .7857						Average Rebar Size = 4.44				
Total 4.4 Tons	100	8,666	39	3,367	24	2,067	9	773	28	2,459

Bid Date -

**** TOTALS PAGE (LBS) ****

SHEARWALL	STRUCTURE TOTAL		STRAIGHT		LIGHT BENT		HEAVY BENT		STOCK/MILL	
SIZE	%	Weight	%	Weight	%	Weight	%	Weight	%	Weight
#3 Gr 60	100	719			100	719				
#4 Gr 60	100	55,166	86	47,214	14	7,952				
#5 Gr 60	100	8,969	80	7,133			20	1,836		
Average Lbs per Linear Feet = .6966					Average Rebar Size = 4.13					
Total 32.5 Tons	100	64,854	84	54,347	13	8,671	3	1,836		

CMU WALL	STRUCTURE TOTAL		STRAIGHT		LIGHT BENT		HEAVY BENT		STOCK/MILL	
SIZE	%	Weight	%	Weight	%	Weight	%	Weight	%	Weight
#5 Gr 60	100	15,165	41	6,153					59	9,012
Average Lbs per Linear Feet = 1.0430					Average Rebar Size = 5.00					
Total 7.6 Tons	100	15,165	41	6,153					59	9,012

UPPER LEVEL	STRUCTURE TOTAL		STRAIGHT		LIGHT BENT		HEAVY BENT		STOCK/MILL	
SIZE	%	Weight	%	Weight	%	Weight	%	Weight	%	Weight
#3 Gr 60	100	438			52	227			48	211
#4 Gr 60	100	97,796	36	35,327	36	34,797	14	14,018	14	13,654
#5 Gr 60	100	44,861	80	36,032		30	20	8,799		
#6 Gr 60	100	15,688	49	7,731	12	1,917	39	6,040		
#7 Gr 60	100	9,298	20	1,902			80	7,396		
Average Lbs per Linear Feet = .8176					Average Rebar Size = 4.62					
Total 84.1 Tons	100	168,081	48	80,992	22	36,971	22	36,253	8	13,865

Bid Date -

**** TOTALS PAGE (LBS) ****

SITWORK	STRUCTURE TOTAL		STRAIGHT		LIGHT BENT		HEAVY BENT		STOCK/MILL	
SIZE	%	Weight	%	Weight	%	Weight	%	Weight	%	Weight
#3 Gr 60	100	37			100	37				
#4 Gr 60	100	2,538							100	2,538
#6 Gr 60	100	30	100	30						
Average Lbs per Linear Feet = .6649					Average Rebar Size = 4.01					
Total 1.4 Tons	100	2,605	1	30	1	37			97	2,538

GRAND TOTALS	TOTAL		STRAIGHT		LIGHT BENT		HEAVY BENT		STOCK/MILL	
SIZE	%	Weight	%	Weight	%	Weight	%	Weight	%	Weight
#3 Gr 60	100	52,742		21	100	52,510				211
#4 Gr 60	100	165,483	51	84,115	28	46,561	8	14,018	13	20,789
#5 Gr 60	100	75,783	70	52,839		30	18	13,902	12	9,012
#6 Gr 60	100	17,430	52	8,977	11	1,917	37	6,536		
#7 Gr 60	100	153,743	81	124,332			19	29,411		
#8 Gr 60	100	42,078	90	38,029			10	4,049		
Average Lbs per Linear Feet = .9006					Average Rebar Size = 5.36					
Total 253.7 Tons	100	507,259	61	308,313	20	101,018	13	67,916	6	30,012

